

**STAINLESS STEEL
WELDED & PN 10 FLANGED
PROPORTIONAL SAFETY VALVE**

SERIES : 731

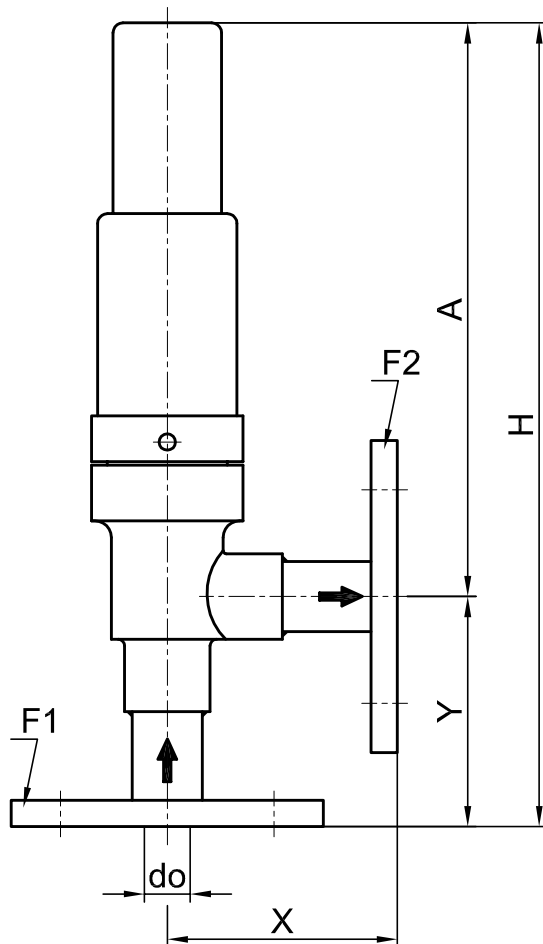

| DN | do (Ø) | X | Y | A | H | F1 | F2 |
|---------|--------|-----|-----|-----|-----|-------|-------|
| 15 / 15 | 15 | 70 | 70 | 180 | 250 | DN 15 | DN 15 |
| 20 / 20 | 15 | 80 | 80 | 180 | 260 | DN 20 | DN 20 |
| 25 / 25 | 17 | 90 | 90 | 205 | 295 | DN 25 | DN 25 |
| 32 / 32 | 22 | 100 | 100 | 215 | 315 | DN 32 | DN 32 |
| 40 / 40 | 27 | 110 | 110 | 280 | 390 | DN 40 | DN 40 |
| 50 / 50 | 34 | 115 | 115 | 285 | 400 | DN 50 | DN 50 |

Set Pressure Range : 0.1 - 6 bar (2 - 87 psi)



ALFANOX